

# Integra®

## PRESS KIT



## About Integra

Integra has been synonymous with high fidelity since 1969, when the name identified industry-leading flagship amplifiers. Thirty years later in 1999, Integra launched as a standalone brand dedicated to emerging home installation markets with a range of solutions that dealers and installers could stake their reputations on.

Because of our close relationship with these professionals, the Integra lineup continues to evolve organically with the needs of a rapidly changing marketplace while exceeding the high expectations of our customers.

## What's New in 2021

2021 brings an exciting new product set from Integra, including these key features:

- Dirac Live
- HDMI 2.1 & 8K
- Advanced Custom Integration Tools

## 2021 Feature Set

### Dirac Live

Dirac Live® is an advanced digital room correction technology that utilizes sophisticated analysis of the speakers and the room to correct unwanted colorations, yielding astonishing improvements in sound quality. With Dirac Live and compatible Integra receiver, the listener will experience, improved staging (localization of sound events), better clarity and intelligibility in music and vocals, A deeper and tighter bass free of resonances throughout the entire listening area.



### HDMI 2.1 & 8K

The new wave of 8K TVs is ushering in a new paradigm of much higher bandwidth, better audio, and faster gameplay. With a long history of innovative firsts in the AV world, we have embraced HDMI 2.1 and all it can offer in 2021. This includes higher refresh rates---doubling today's standard refresh rate of 60Hz, or 60fps maximum at 4K resolution, to 120Hz, or 120fps at 4K resolution, and Variable Refresh Rate (VRR), which reduces lag and frame tearing for more fluid and better detailed gameplay.



### Advanced CI Tools

Integrators have asked for compatibility with remote monitoring platforms to help manage, configure, and troubleshoot devices on the network, saving countless hours and expenses from truck rolls.

Integra AVRs work with the leading remote monitoring and management platforms, giving the integrator fast remote access to system status, ability to make adjustment on the fly, and easy secure access to web setup.

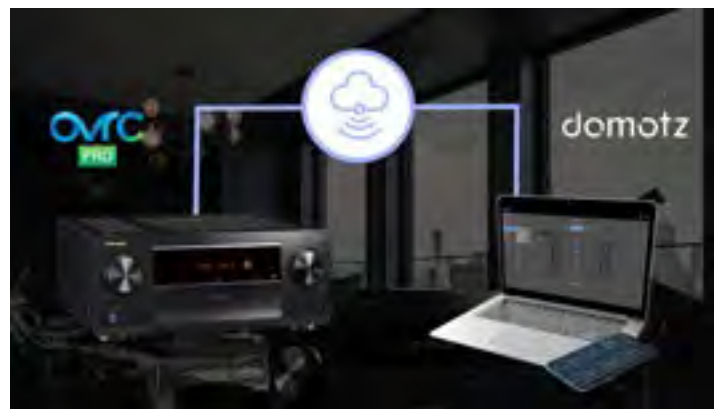

## **New Products in 2021**

---



### AUDIO & VIDEO HIGHLIGHTS

- 5.2.4/7.2.2-ch Dolby Atmos® and DTS:X® playback
- Dolby Atmos Height Virtualization
- Dolby Surround® and DTS® Neural:X upmixing
- HDMI®\*1 supports 8K/60p (4:4:4/12-bit<sup>2</sup>, 4:2:2/12-bit<sup>2</sup>, 4:2:0/10-bit<sup>3</sup>), 8K/30p (4:4:4/12-bit<sup>2</sup>, 4:4:4/10-bit<sup>3</sup>, 4:2:2/12-bit<sup>3</sup>, 4:2:0/12-bit), 4K/120p (4:4:4/12-bit<sup>2</sup>, 4:4:4/10-bit<sup>3</sup>, 4:2:2/12-bit<sup>3</sup>, 4:2:0/12-bit) video passthrough, HDR10+, Dolby Vision™, HDR10, HLG, BT.2020, VRR (Variable Refresh Rate), DSC (Display Stream Compression), ALLM (Auto Low Latency Mode), QFT (Quick Frame Transport), QMS (Quick Media Switching), eARC (enhanced Audio Return Channel), DeepColor™, x.v.Color™, LipSync, and HDCP 2.3
- 11.2-ch pre-outs<sup>4</sup> and processing for 7.2.4-ch<sup>5</sup> layouts
- HDMI Main Out with eARC for encoded HQ audio, Sub/Zone 2 Out with OSD<sup>6</sup>
- Bidirectional Bluetooth® wireless technology Version 4.2 + LE (A2DP v1.2, AVRCP v1.3; RX: SBC/AAC, TX: SBC/Qualcomm® aptX™/apt X HD)
- Separate Zone 2 speaker outputs enable 5.2.4-ch + Zone 2 speaker connection, 5.2.4-ch playback switching to 5.2.2-ch + Zone 2 playback<sup>7</sup>
- Dedicated DACs support synced/independent D/A audio distribution in Zone 2 and Zone 3 (including HDMI/SPDIF/NET<sup>8</sup>) via Zone 2 and Zone 3 speaker outputs, Zone 2 pre-out<sup>9</sup> and Zone 3 pre-out<sup>4</sup>
- Share any MAIN audio source to a wireless headphone dock via Zone B line-out<sup>9</sup>
- Phono equalizer (MM) and SACD (Super Audio CD) playback via HDMI (2.8 MHz 2-ch/multichannel)
- Dirac Live® Room Correction supports multi-point acoustic calibration
- AccuReflex™ phase-matching solution for Dolby Atmos enabled speakers
- Original DSP-based Vocal Enhancer clarifies in-program vocals/dialog

### AMPLIFICATION TECHNOLOGY

- 120 W per channel (8 ohms, 20 Hz–20 kHz, 0.08% THD, 2-ch driven, FTC)
- THX® Certified Select for Theater Reference Sound
- IMAX® Enhanced certified for IMAX® digital remasters
- Low-impedance amp system with 4-ohm speaker-driving capability
- Massive custom transformer and customized 15,000 µF capacitors
- Copper bus-bar connects capacitors to amplifiers
- Non-phase-shift amp-circuit topology, audio-grade parts, and separate digital/analog circuit boards
- Extruded anti-resonant aluminum heat-sink
- Precision DAC supports 192 kHz/24-bit multichannel D/A conversion
- VLSC™ (Vector Linear Shaping Circuitry) filtering technology (Front L/R)
- PLL (Phase-Locked Loop) jitter-cleaning circuitry for SPDIF digital audio
- Front L/R speaker bi-amping capability in 5.2/7.2/5.2.2-ch configuration
- Independent tone controls (bass/treble) for all channels

### NETWORK FEATURES AND MULTI-ZONE AUDIO

- Isolated quad-core SoC board supports high-speed 802.11ac (2x2 MIMO<sup>10</sup>) Wi-Fi®
- Amazon Music HD<sup>11</sup>, Spotify®, TIDAL, TuneIn, Pandora®, and Deezer<sup>12</sup>
- Works with Sonos supporting multiple Sonos Connect/Port control and Volume Passthrough mode<sup>13</sup>
- Works with Alexa supporting multi-room music<sup>14</sup>
- Works with Hey Google<sup>15</sup> and Chromecast built-in™
- AirPlay 2 multi-room audio with Siri voice control
- DTS Play-Fi®<sup>16</sup> multi-room audio via Integra Music Control App<sup>17</sup>
- Compatible with the Integra Remote app for iPad®, iPhone®, and Android™<sup>18</sup>
- Room Tested certified for the Room Core
- Hi-Res Audio via network (DSD 11.2 MHz/5.6 MHz/2.8 MHz<sup>18</sup>, FLAC, WAV [RIFF], ALAC, and AIFF to 192 kHz/24-bit<sup>19</sup>)

## Welcome Extraordinary into Your Home

Theater-reference Dolby Atmos® or DTS:X® sound through up to 7.2.4 channels\* complements 8K HDR video passthrough. Connect 5.2.4-ch speakers and Zone 2 speakers and switch between 5.2.4-ch and 5.2.2-ch + Zone 2 playback, or use 5 GHz/2.4 GHz Wi-Fi® and your voice to control music all around your home.

\* Requires connection of an external stereo power amp.

### AUDIO-VIDEO CONNECTIONS

- 7 HDMI inputs (1 front), Main Out (eARC), Sub/Zone 2 Out
- 2 digital audio inputs (rear, 1 optical, 1 gold-plated coaxial, assignable)
- 6 gold-plated analog audio inputs (rear, assignable)
- Gold-plated phono input and built-in equalizer (MM) for turntable connection
- USB input (5 V/1 A) for audio playback (rear)
- 1/8" (3.5 mm) Dirac Live/AccuEQ Advance setup mic input (front)
- 2 gold-plated composite video inputs (rear, assignable)
- 1 gold-plated component video input (rear, assignable)
- 1/4" (6.3 mm) gold-plated headphone jack
- 11 gold-plated banana-plug-ready speaker posts with transparent knobs (including Zone 2)
- Dedicated gold-plated Zone 2 speaker outputs<sup>7</sup>
- Gold-plated 11.2-ch pre-outs<sup>4</sup>
- Gold-plated Zone 2 pre-out / Zone B line-out (analog RCA<sup>9</sup>)
- Ethernet LAN terminal

### CUSTOM INTEGRATION FEATURES

- 10BASE-T/100BASE-TX Ethernet supports setup and IP control via web browser
- Works with Crestron®, Control4®, Savant, URC, ELAN, and RTI automation
- RS-232 input for external control and automation
- 2 IR inputs and 1 output
- 3 programmable 12 V trigger-outs with adjustable delay (A: 100 mA, B: 25 mA, C: 25 mA)
- Dealer-settings memory storage and recall function
- AC inlet for detachable IEC power cable
- Optional rack-mount kit (IRK-180-4C)

### ADDITIONAL FEATURES

- Aluminum front panel and volume knob
- Front-to-Surround/Height speaker switching in Stereo Assign Mode
- One-touch volume memory preset assignment to individual A/V inputs via front panel
- OSD function displays A/V input signal data, output signal/settings data, and network information
- Dolby® TrueHD and DTS-HD Master Audio® decoding
- THX® listening modes for films, games, and music
- Advanced Music Optimizer™ improves compressed audio playback quality
- High-definition GUI over HDMI
- Super Resolution 1080p to 4K and 1080p/4K to 8K video upscaling via HDMI
- Crossover Adjustment (40/45/50/55/60/70/80/90/100/110/120/130/150/180/200 Hz)
- A/V Sync Control (Up to 500 ms in 1 ms steps at 48 kHz<sup>20</sup>)
- Sleep timer, HDMI passthrough, and network standby
- 40 FM/AM/internet radio presets with station-naming (10 characters)
- 3-Mode display dimmer (Normal/Dim/Dimmer)

<sup>1</sup> Features defined in HDMI 2.1 specification, HDR10+, and passthrough capabilities described are supported on HDMI inputs 1–6, Main Out, and Sub/Zone 2 Out in Sub Mode output. <sup>2</sup> DSC signals only. <sup>3</sup> DSC signals only when input via HDMI inputs 4–6. <sup>4</sup> Height 2 and Zone 3 pre-outs are exclusive modes shared on the same analog RCA output. <sup>5</sup> Requires connection of an external stereo power amplifier. <sup>6</sup> HDMI Zone 2 Mode output supports signals via HDMI inputs 1–3. <sup>7</sup> Playback via Height 2 (5.2.4-ch layout) or Surround Back (7.2.2-ch layout) speaker outputs is unavailable when playing in 5.2.2/7.2.2 + Zone 2 speaker output mode. Output via Zone 2 speaker output and Zone 2 pre-out enabled. <sup>8</sup> Zone 2 HDMI audio is available on inputs 1–3. SPDIF and HDMI support PCM signals only. Zone 3 supports analog/NET only. <sup>9</sup> Zone 2 pre-out and Zone B line-out are exclusive modes shared on the same analog RCA output. <sup>10</sup> Some countries or regions have regulations that affect wireless signal strength and the use of Wi-Fi channels. <sup>11</sup> Amazon Music HD is supported via DTS Play-Fi. <sup>12</sup> Service availability varies with region, and a paid subscription may be required. <sup>13</sup> Requires Sonos Connect or Port (sold separately). Connection of 1–3 Sonos devices is supported with volume control enabled via the Sonos app. Sonos app available free for compatible iPhone® and iPad® at the App Store. Available free for compatible Android™ devices at the Google Play Store. <sup>14</sup> Voice control requires an Amazon Alexa enabled device. Alexa multi-room music may require a firmware update. <sup>15</sup> Voice control requires a Google Assistant enabled device. <sup>16</sup> Enabled with a future firmware update. <sup>17</sup> Available free for compatible iPhone, iPad, and Android devices. <sup>18</sup> Converted to PCM. Playback not guaranteed via wireless LAN. <sup>19</sup> Supported sampling rates may vary depending on network environment. ALAC is supported to a maximum 96 kHz. <sup>20</sup> Max. 400 ms (1 ms steps) at 96 kHz, and max. 200 ms (1 ms steps) at 192 kHz.

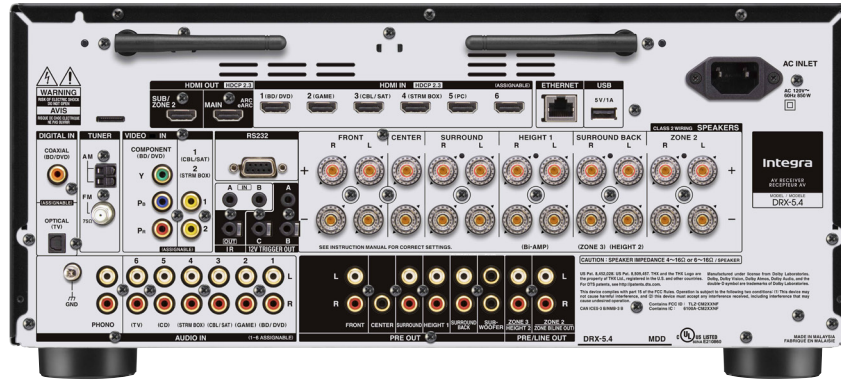
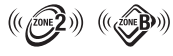

### SPECIFICATIONS

#### AMPLIFIER SECTION

Power Output  
Front L/R: 250 W/Ch at 6 Ohms, 1 kHz, 10%,  
1 Channel Driven,  
120 W/Ch at 8 Ohms, 20 Hz–20 kHz, 0.08%,  
2 Channels Driven, FTC

Dynamic Power: 250 W (3 Ohms, Front)  
220 W (4 Ohms, Front)  
130 W (8 Ohms, Front)

Input Sensitivity and Impedance: 200 mV rms/47 k-Ohms (Line/Unbalance)  
3.5 mV rms/47 k-Ohms (Phono MM)

THD+N (Total Harmonic Distortion + Noise): 0.08% (20 Hz–20 kHz, Half Power)

Rated RCA Output Level and Impedance: 1 V rms/470 Ohms (Subwoofer Pre-out)  
200 mV rms/470 Ohms (Zone 3/Height 2/Pre-/Line-out)

Phono Overload: 70 mV (MM, 1 kHz, 0.5%)

Frequency Response: 10 Hz–100 kHz/+1 dB, -3 dB (Direct Mode)

Tone Control: ±10 dB, 20 Hz (Bass)  
±10 dB, 20 kHz (Treble)

Signal-to-Noise Ratio: 106 dB (IHF-A, Line)  
80 dB (IHF-A, Phono)

Speaker Impedance: 4 Ohms–16 Ohms

#### VIDEO SECTION

Signal Level 1 Vp-p/75 Ohms Composite Video  
1 Vp-p/75 Ohms Component Video (Y)  
0.7 Vp-p/75 Ohms Component Video (Pb/Pr)

#### TUNER SECTION

Tuning Frequency Range: FM 87.5 MHz–107.9 MHz  
AM 530 kHz–1,710 kHz

FM/AM Preset Memory: 40 Stations

#### GENERAL

Power Supply: AC 120 V~, 60 Hz

Power Consumption: 850 W

Standby Power Consumption: 0.1 W

Dimensions (W x H x D): 17 1/8" x 7 13/16" x 15 5/16"  
(435 x 198 x 388.5 mm)

Weight: 30.9 lbs. (14.0 kg)

CARTON

Dimensions (W x H x D): 22 1/16" x 12 5/8" x 18 3/16"  
(560 x 320 x 462 mm)

Weight: 37.5 lbs. (17.0 kg)

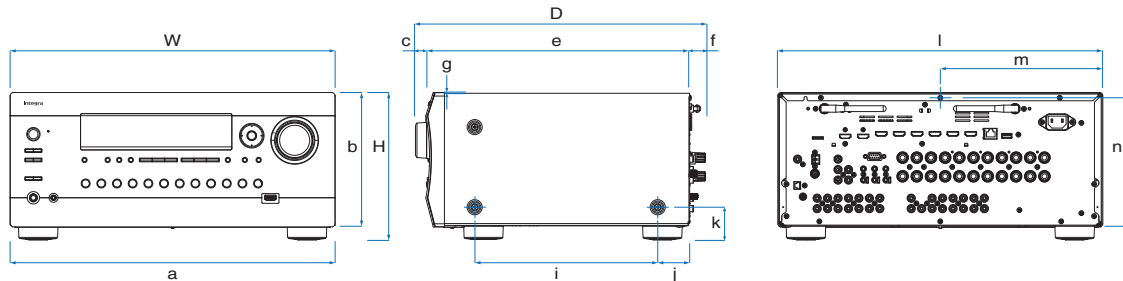

W	H	D	a	b
17 1/8" (435 mm)	7 13/16" (198 mm)	15 5/16" (388.5 mm)	17 1/8" (435 mm)	7 1/16" (180 mm)
c	e	f	g	i
15 1/16" (23.8 mm)	13 1/2" (343.5 mm)	13 1/16" (21.2 mm)	1 1/16" (1 mm)	9 5/8" (245.2 mm)
j	k	l	m	n
1 11/16" (42.8 mm)	1 3/4" (44 mm)	17 1/16" (433 mm)	8 1/2" (216.5 mm)	7 1/2" (190.6 mm)

Due to a policy of continuous product improvement, Integra reserves the right to change specifications and appearance without notice. THX and the THX Logo are the property of THX Ltd., registered in the U.S. and other countries. Dolby, Dolby Atmos, Dolby Surround, Dolby Vision, and the double-D symbol are trademarks of Dolby Laboratories. For DTS patents, see <http://patents.dts.com>. Manufactured under license from DTS Licensing Limited. DTS, the Symbol, DTS and the Symbol together, DTS:X and the DTS:X logo, DTS Neural:X and the DTS Neural:X logo, and Play-Fi and the Play-Fi logo are registered trademarks or trademarks of DTS, Inc. © DTS, Inc. All Rights Reserved. Manufactured under license from IMAX Corporation. IMAX® is a registered trademark of IMAX Corporation in the United States and/or other countries. All Rights Reserved. The terms HDMI and HDMI High-Definition Multimedia Interface, and the HDMI Logo are trademarks or registered trademarks of HDMI Licensing Administrator, Inc. in the United States and other countries. SONOS is a trademark of SONOS, Inc. The Bluetooth® word mark and logos are owned by the Bluetooth SIG, Inc. AirPlay, Siri, iPad, and iPhone are registered trademarks of Apple Inc. Google, Android, Chromecast built-in and other related marks and logos are trademarks of Google LLC. Wi-Fi® is a registered trademark of the Wi-Fi Alliance. The Wi-Fi CERTIFIED Logo is a certification mark of the Wi-Fi Alliance. Spotify and the Spotify logo are trademarks of the Spotify Group, registered in the U.S. and other countries. Roon is a trademark of Roon, LLC, registered in the U.S. and other countries. Products displaying the Hi-Res Audio logo conform to the Hi-Res Audio standard as defined by Japan Audio Society. The Hi-Res Audio logo is used under license from Japan Audio Society. PANDORA, the PANDORA logo, and the Pandora trade dress are trademarks or registered trademarks of Pandora Media, Inc. Used with permission. Amazon, Alexa, Amazon Music, and all related logos are trademarks of Amazon.com, Inc. or its affiliates. Qualcomm is a trademark of Qualcomm Incorporated, registered in the United States and other countries. aptX is a trademark of Qualcomm Technologies International, Ltd., registered in the United States and other countries. Qualcomm aptX is a product of Qualcomm Technologies, Inc. and/or its subsidiaries. Dirac Live® is a registered trademark of Dirac Research AB protected by Swedish and international trademark laws and treaties. Integra Remote, Integra Music Control App, Music Optimizer, VLSC, and AccuEQ are registered trademarks or trademarks of Onkyo Home Entertainment Corporation. All other trademarks and registered trademarks are the property of their respective holders.





## A Perfect Blend of Features, Ready to Integrate

Just right for your living room, media room, or bespoke home theater, the DRX-3.4 has power to drive Dolby Atmos® and DTS:X® through 5.2.4 channels with 8K HDR video passthrough, making it perfect for IMAX® Enhanced content. Share the sound around your home by app or voice over 5 GHz/2.4 GHz Wi-Fi® or via Zone 2 and Zone 3 powered speaker outputs.

### AUDIO & VIDEO HIGHLIGHTS

- 5.2.4/7.2.2-ch Dolby Atmos® and DTS:X® playback
- Dolby Atmos Height Virtualization
- Dolby Surround® and DTS® Neural:X upmixing
- HDMI®<sup>1</sup> supports 8K/60p (4:4:4/12-bit<sup>2</sup>, 4:2:2/12-bit<sup>2</sup>, 4:2:0/10-bit<sup>3</sup>), 8K/30p (4:4:4/12-bit<sup>2</sup>, 4:4:4/10-bit<sup>3</sup>, 4:2:2/12-bit<sup>3</sup>, 4:2:0/12-bit), 4K/120p (4:4:4/12-bit<sup>2</sup>, 4:4:4/10-bit<sup>3</sup>, 4:2:2/12-bit<sup>3</sup>, 4:2:0/12-bit) video passthrough, HDR10+, Dolby Vision™, HDR10, HLG, BT.2020, VRR (Variable Refresh Rate), DSC (Display Stream Compression), ALLM (Auto Low Latency Mode), QFT (Quick Frame Transport), QMS (Quick Media Switching), eARC (enhanced Audio Return Channel), DeepColor™, x.v.Color™, LipSync, and HDCP 2.3
- HDMI Main Out with eARC for encoded HQ audio, Sub/Zone 2 Out with OSD<sup>4</sup>
- Bidirectional Bluetooth® wireless technology Version 4.2 + LE (A2DP v1.2, AVRCP v1.3; RX: SBC/AAC, TX: SBC/Qualcomm® aptX™/apt X HD)
- 9.2-ch multichannel pre-outs<sup>5</sup>
- Dedicated DACs support synced/independent D/A audio distribution in Zone 2 and Zone 3 (including HDMI/SPDIF/NET<sup>6</sup>) via Zone 2<sup>7</sup> and Zone 3 speaker outputs, Zone 2 pre-out<sup>8</sup> and Zone 3 pre-out<sup>5</sup>
- Share any MAIN audio source to a wireless headphone dock via Zone B line-out<sup>8</sup>
- Phono equalizer (MM) and SACD (Super Audio CD) playback via HDMI (2.8 MHz 2-ch/multichannel)
- Dirac Live® Room Correction supports multi-point acoustic calibration
- AccuReflex™ phase-matching solution for Dolby Atmos enabled speakers
- Original DSP-based Vocal Enhancer clarifies in-program vocals/dialog

### AMPLIFICATION TECHNOLOGY

- 100 W per channel (8 ohms, 20 Hz–20 kHz, 0.08% THD, 2-ch driven, FTC)
- IMAX® Enhanced certified for IMAX® digital remasters
- Low-impedance amp system with 4-ohm speaker-driving capability
- Massive custom transformer and hand-selected audio parts
- Non-phase-shift amp-circuit topology for clear and cohesive sound
- Optimum Gain Volume Circuitry
- Precision DAC supports 192 kHz/24-bit multichannel D/A conversion
- VLSC™ (Vector Linear Shaping Circuitry) filtering technology (Front L/R)
- Front L/R speaker bi-amping capability in 5.2/7.2/5.2.2-ch configuration
- PLL (Phase-Locked Loop) jitter-cleaning circuitry for SPDIF digital audio
- Independent tone controls (bass/treble) for all channels

### NETWORK FEATURES AND MULTI-ZONE AUDIO

- Isolated quad-core SoC board supports high-speed 802.11ac (2x2 MIMO<sup>9</sup>) Wi-Fi®
- Amazon Music HD<sup>11</sup>, Spotify®, TIDAL, TuneIn, Pandora®, and Deezer<sup>10</sup>
- Works with Sonos supporting multiple Sonos Connect/Port control and Volume Passthrough mode<sup>12</sup>
- Works with Alexa supporting multi-room music<sup>13</sup>
- Works with Hey Google<sup>14</sup> and Chromecast built-in™
- AirPlay 2 multi-room audio with Siri voice control
- DTS Play-Fi®<sup>15</sup> multi-room audio via Integra Music Control App<sup>16</sup>
- Compatible with the Integra Remote app for iPad®, iPhone®, and Android™<sup>16</sup>
- Roon Tested certified for the Roon Core
- Hi-Res Audio via network (DSD 11.2 MHz/5.6 MHz/2.8 MHz<sup>17</sup>, FLAC, WAV [RIFF], ALAC, and AIFF to 192 kHz/24-bit<sup>18</sup>)

### AUDIO-VIDEO CONNECTIONS

- 7 HDMI inputs (1 front), Main Out (eARC), Sub/Zone 2 Out
- 2 digital audio inputs (rear, 1 optical, 1 gold-plated coaxial, assignable)
- 7 gold-plated analog audio inputs (6 rear, assignable, 1 front)
- Gold-plated phono input and built-in equalizer (MM) for turntable connection
- USB input (5 V/1 A) for audio playback (rear)
- 1/8" (3.5 mm) Dirac Live/AccuEQ Advance setup mic input (front)
- 3 gold-plated composite video inputs (2 rear, assignable, 1 front)
- 1 gold-plated component video input (rear, assignable)
- 1/4" (6.3 mm) gold-plated headphone jack
- 9 gold-plated banana-plug-ready speaker posts with transparent knobs
- Gold-plated 9.2-ch pre-outs<sup>5</sup>
- Gold-plated Zone 2 pre-out / Zone B line-out (analog RCA<sup>8</sup>)
- Ethernet LAN terminal

### CUSTOM INTEGRATION FEATURES

- 10BASE-T/100BASE-TX Ethernet supports setup and IP control via web browser
- Works with Crestron®, Control4®, Savant, URC, ELAN, and RTI automation
- RS-232 input for external control and automation
- 2 IR inputs and 1 output
- 3 programmable 12 V trigger-outs with adjustable delay (A: 100 mA, B: 25 mA, C: 25 mA)
- Dealer-settings memory storage and recall function
- AC inlet for detachable IEC power cable
- Optional rack-mount kit (IRK-155-3D)

### ADDITIONAL FEATURES

- Aluminum front panel and volume knob
- Front-to-Surround/Height speaker switching in Stereo Assign Mode
- One-touch volume memory preset assignment to individual A/V inputs via front panel
- OSD function displays A/V input signal data, output signal/settings data, and network information
- Dolby® TrueHD and DTS-HD Master Audio® decoding
- Advanced Music Optimizer™ improves compressed audio playback quality
- High-definition GUI over HDMI
- Super Resolution 1080p to 4K and 1080p/4K to 8K video upscaling via HDMI
- Crossover Adjustment (40/45/50/55/60/70/80/90/100/110/120/130/150/180/200 Hz)
- A/V Sync Control (Up to 500 ms in 1 ms steps at 48 kHz<sup>19</sup>)
- Sleep timer, HDMI passthrough, and network standby
- 40 FM/AM/internet radio presets with station-naming (10 characters)
- 3-Mode display dimmer (Normal/Dim/Dimmer)

<sup>1</sup> Features defined in HDMI 2.1 specification, HDR10+, and passthrough capabilities described are supported on HDMI inputs 1–6, Main Out, and Sub/Zone 2 Out in Sub Mode output. <sup>2</sup> DSC signals only. <sup>3</sup> DSC signals only when input via HDMI inputs 4–6. <sup>4</sup> HDMI Zone 2 Mode output supports signals via HDMI inputs 1–3. <sup>5</sup> Height 2, Surround Back, and Zone 3 pre-outs are exclusive modes shared on the same analog RCA output. <sup>6</sup> Zone 2 HDMI audio is available on inputs 1–3. SPDIF and HDMI support PCM signals only. Zone 3 supports analog/NET only. <sup>7</sup> Output via Zone 2 speaker output and Zone 2 pre-out enabled. <sup>8</sup> Zone 2 pre-out and Zone B line-out are exclusive modes shared on the same analog RCA output. <sup>9</sup> Some countries or regions have regulations that affect wireless signal strength and the use of Wi-Fi channels. <sup>10</sup> Service availability varies with region, and a paid subscription may be required. <sup>11</sup> Amazon Music HD is supported via DTS Play-Fi. <sup>12</sup> Requires Sonos Connect or Port (sold separately). Connection of 1–2 Sonos devices is supported with volume control enabled via the Sonos app. Sonos app available free for compatible iPhone® and iPad® at the App Store. Available free for compatible Android™ devices at the Google Play Store. <sup>13</sup> Voice control requires an Amazon Alexa enabled device. Alexa multi-room music may require a firmware update. <sup>14</sup> Voice control requires a Google Assistant enabled device. <sup>15</sup> Enabled with a future firmware update. <sup>16</sup> Available free for compatible iPhone, iPad, and Android devices. <sup>17</sup> Converted to PCM. Playback not guaranteed via wireless LAN. <sup>18</sup> Supported sampling rates may vary depending on network environment. ALAC is supported to a maximum 96 kHz. <sup>19</sup> Max. 400 ms (1 ms steps) at 96 kHz, and max. 200 ms (1 ms steps) at 192 kHz.

## 9.2-CHANNEL NETWORK A/V RECEIVER

IMAX  
ENHANCED

8K4K

HDR+

COMPATIBLE WITH

Dolby Vision

Dolby Atmos

DTS X

DIRAC

deezer

TIDAL

Spotify

pandora

amazon music

TUNE IN

Bluetooth

WiFi  
CERTIFIED

Qualcomm  
aptX

Bluetooth

DTS  
Play-Fi

Chromecast  
built-in

room  
tested

Hi-Res  
AUDIO

VLSC

works with  
Hey Google

WORKS WITH  
alexa

Works with  
SONOS

Dolby Digital  
Dolby Digital

Dolby Digital  
Dolby Digital

8K GAMING

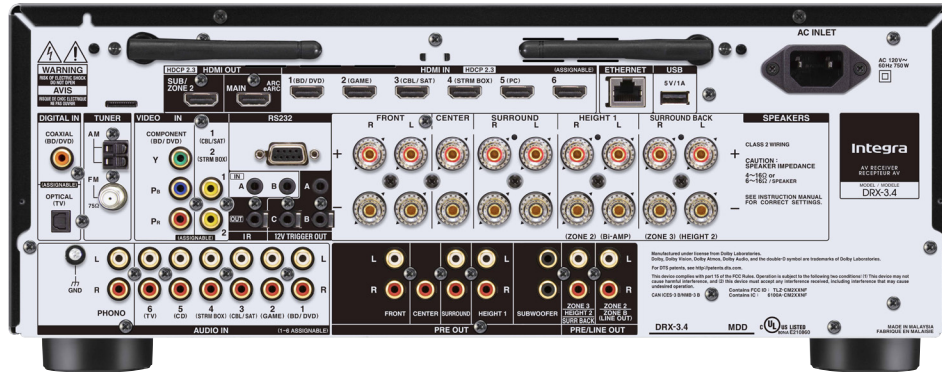

### SPECIFICATIONS

#### AMPLIFIER SECTION

Power Output  
Front L/R: 225 W/Ch at 6 Ohms, 1 kHz, 10%,  
1 Channel Driven,  
100 W/Ch at 8 Ohms, 20 Hz–20 kHz, 0.08%,  
2 Channels Driven, FTC

Dynamic Power: 250 W (3 Ohms, Front)  
220 W (4 Ohms, Front)  
130 W (8 Ohms, Front)

Input Sensitivity and Impedance: 200 mV rms/47 k-Ohms (Line/Unbalance)  
3.5 mV rms/47 k-Ohms (Phono MM)

THD+N (Total Harmonic Distortion + Noise): 0.08% (20 Hz–20 kHz, Half Power)

Rated RCA Output Level and Impedance: 1 V rms/470 Ohms (Subwoofer Pre-out)  
200 mV rms/470 Ohms  
(Zone 3/Height 2/Surround Back Pre-/Line-out)

Phono Overload: 70 mV (MM, 1 kHz, 0.5%)

Frequency Response: 10 Hz–100 kHz/+1 dB, -3 dB (Direct Mode)

Tone Control: ±10 dB, 20 Hz (Bass)  
±10 dB, 20 kHz (Treble)

Signal-to-Noise Ratio: 106 dB (IHF-A, Line)  
80 dB (IHF-A, Phono)

Speaker Impedance: 4 Ohms–16 Ohms

#### VIDEO SECTION

Signal Level 1 Vp-p/75 Ohms Composite Video  
1 Vp-p/75 Ohms Component Video (Y)  
0.7 Vp-p/75 Ohms Component Video (Pb/Pr)

#### TUNER SECTION

Tuning Frequency Range: FM 87.5 MHz–107.9 MHz  
AM 530 kHz–1,710 kHz

FM/AM Preset Memory: 40 Stations

#### GENERAL

Power Supply: AC 120 V~, 60 Hz

Power Consumption: 750 W

Standby Power Consumption: 0.1 W

Dimensions (W x H x D): 17 1/8" x 6 7/8" x 14 13/16"  
(435 x 174 x 376.5 mm)

Weight: 24.3 lbs. (11.0 kg)

CARTON

Dimensions (W x H x D): 22 1/16" x 12" x 18 3/8"  
(560 x 305 x 467 mm)

Weight: 29.8 lbs. (13.5 kg)

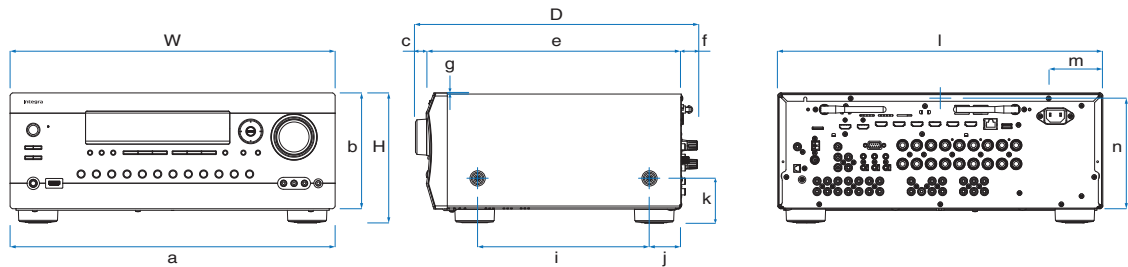

W	H	D	a	b
17 1/8" (435 mm)	6 7/8" (174 mm)	14 13/16" (376.5 mm)	17 1/8" (435 mm)	6 1/8" (155 mm)
c	e	f	g	i
15 1/16" (24.5 mm)	13" (330.5 mm)	7/8" (21.5 mm)	1/16" (1.5 mm)	9 1/16" (229.5 mm)
j	k	l	m	n
1 11/16" (42.5 mm)	2 3/8" (60.8 mm)	17 1/16" (433 mm)	2 13/16" (71.5 mm)	6 5/8" (167.5 mm)

Due to a policy of continuous product improvement, Integra reserves the right to change specifications and appearance without notice. Dolby, Dolby Atmos, Dolby Surround, Dolby Vision, and the double-D symbol are trademarks of Dolby Laboratories. For DTS patents, see <http://patents.dts.com>. Manufactured under license from DTS Licensing Limited. DTS, the Symbol, DTS and the Symbol together, DTS:X logo, DTS Neural:X and the DTS Neural:X logo, and Play-Fi and the Play-Fi logo are registered trademarks or trademarks of DTS, Inc. © DTS, Inc. All Rights Reserved. Manufactured under license from IMAX Corporation. IMAX® is a registered trademark of IMAX Corporation in the United States and/or other countries. All Rights Reserved. The terms HDMI and HDMI High-Definition Multimedia Interface, and the HDMI Logo are trademarks or registered trademarks of HDMI Licensing Administrator, Inc. in the United States and other countries. SONOS is a trademark of SONOS, Inc. The Bluetooth® word mark and logos are owned by the Bluetooth SIG, Inc. AirPlay, Siri, iPad, and iPhone are registered trademarks of Apple Inc. Google, Android, Chromecast built-in and other related marks and logos are trademarks of Google LLC. Wi-Fi® is a registered trademark of the Wi-Fi Alliance. The Wi-Fi CERTIFIED Logo is a certification mark of the Wi-Fi Alliance. Spotify and the Spotify logo are trademarks of the Spotify Group, registered in the U.S. and other countries. Room is a trademark of Room, LLC, registered in the U.S. and other countries. Products displaying the Hi-Res Audio logo conform to the Hi-Res Audio standard as defined by Japan Audio Society. The Hi-Res Audio logo is used under license from Japan Audio Society. PANDORA, the PANDORA logo, and the Pandora trade dress are trademarks or registered trademarks of Pandora Media, Inc. Used with permission. Amazon, Alexa, Amazon Music, and all related logos are trademarks of Amazon.com, Inc. or its affiliates. Qualcomm is a trademark of Qualcomm Incorporated, registered in the United States and other countries. aptX is a trademark of Qualcomm Technologies International, Ltd., registered in the United States and other countries. Qualcomm aptX is a product of Qualcomm Technologies, Inc. and/or its subsidiaries. Dirac Live® is a registered trademark of Dirac Research AB protected by Swedish and international trademark laws and treaties. Integra Remote, Integra Music Control App, Music Optimizer, VLSC, and AccuEQ are registered trademarks or trademarks of Onkyo Home Entertainment Corporation. All other trademarks and registered trademarks are the property of their respective holders.





## Prepare for the 8K Theater Revolution

High-spec HDMI® unlocks exciting features for gamers and film lovers in your family, including 8K video passthrough, HDR10+, and low-latency gameplay. Enjoy DTS:X® and Dolby Atmos® 3D soundtracks with refined Integra power and convenient voice-controllable multi-room audio.

### AUDIO & VIDEO HIGHLIGHTS

- 5.2.2-ch Dolby Atmos® and DTS:X® playback
- DTS Virtual:X™ and Dolby Atmos Height Virtualization
- Dolby Surround® and DTS® Neural:X upmixing
- HDMI®<sup>1</sup> supports 8K/60p (4:4:4/12-bit<sup>2</sup>, 4:2:2/12-bit<sup>2</sup>, 4:2:0/10-bit), 8K/30p (4:4:4/12-bit<sup>2</sup>, 4:4:4/10-bit, 4:2:2/12-bit), 4K/120p (4:4:4/12-bit<sup>2</sup>, 4:4:4/10-bit, 4:2:2/12-bit) video passthrough, HDR10+, Dolby Vision™, HDR10, HLG, BT.2020, VRR (Variable Refresh Rate), DSC (Display Stream Compression), ALLM (Auto Low Latency Mode), QFT (Quick Frame Transport), QMS (Quick Media Switching), eARC (enhanced Audio Return Channel), DeepColor™, x.v.Color™, LipSync, and HDCP 2.3
- HDMI Main Out with eARC for encoded HQ audio, Sub/Zone 2 Out with OSD<sup>3</sup>
- Bidirectional Bluetooth® wireless technology Version 4.2 + LE (A2DP v1.2, AVRCP v1.3; RX: SBC/AAC, TX: SBC/Qualcomm® aptX™/apt X HD)
- Separate Zone 2 speaker outputs enable 5.2.2-ch + Zone 2 speaker connection, 5.2.2-ch playback switching to 5.2-ch + Zone 2 playback<sup>4</sup>
- Dedicated Zone 2 DAC supports synced/independent D/A audio distribution (including HDMI/SPDIF/NET<sup>5</sup>) via Zone 2 speaker outputs and Zone 2 pre-out<sup>6</sup>
- Share any MAIN audio source to a wireless headphone dock via Zone B line-out<sup>6</sup>
- Phono equalizer (MM) and SACD (Super Audio CD) playback via HDMI (2.8 MHz 2-ch/multichannel)
- AccuEQ Room Calibration with subwoofer EQ and AccuReflex™
- Original DSP-based Vocal Enhancer clarifies in-program vocals/dialog

### AMPLIFICATION TECHNOLOGY

- 80 W per channel (8 ohms, 20 Hz–20 kHz, 0.08% THD, 2-ch driven, FTC)
- Low-impedance amp system with 4-ohm speaker-driving capability
- Massive custom transformer and hand-selected audio parts
- Non-phase-shift amp-circuit topology for clear and cohesive sound
- Optimum Gain Volume Circuitry
- Precision DAC supports 192 kHz/24-bit multichannel D/A conversion
- VLSC™ (Vector Linear Shaping Circuitry) filtering technology (Front L/R)
- PLL (Phase-Locked Loop) jitter-cleaning circuitry for SPDIF digital audio
- Front L/R speaker bi-amping capability in 5.2-ch configuration
- Tone controls (bass/treble) for Front L/R channels

### NETWORK & MULTI-ZONE AUDIO FEATURES

- Isolated quad-core SoC board supports high-speed 802.11ac (2x2 MIMO<sup>7</sup>) Wi-Fi®
- Supports Amazon Music HD<sup>8</sup>, Spotify®, TIDAL, TuneIn, Pandora®, and Deezer<sup>9</sup>
- Works with Sonos supporting multiple Sonos Connect/Port control and Volume Passthrough mode<sup>10</sup>
- Works with Alexa supporting multi-room music<sup>11</sup>
- Works with Hey Google<sup>12</sup> and Chromecast built-in™
- AirPlay 2 multi-room audio with Siri voice control
- DTS Play-Fi®<sup>13</sup> multi-room audio via Integra Music Control App<sup>14</sup>
- Compatible with the Integra Remote app for iPad®, iPhone®, and Android™<sup>14</sup>
- Room Tested certified for the Room Core
- Hi-Res Audio via network (DSD 11.2 MHz/5.6 MHz/2.8 MHz<sup>15</sup>, FLAC, WAV [RIFF], ALAC, and AIFF to 192 kHz/24-bit<sup>16</sup>)

### AUDIO-VIDEO CONNECTIONS

- 6 HDMI inputs, Main Out (eARC), Sub/Zone 2 Out
- 2 digital audio inputs (rear, 1 optical, 1 gold-plated coaxial, assignable)
- 4 gold-plated analog RCA audio inputs (rear, assignable)
- Gold-plated phono input and built-in equalizer (MM) for turntable connection
- USB input (5 V/1 A) for audio playback (rear)
- Gold-plated 1/8" (3.5 mm) AccuEQ setup mic input (front)
- Gold-plated 1/4" (6.35 mm) headphone jack
- 9 gold-plated banana-plug-ready speaker posts with transparent knobs (including Zone 2)
- Dedicated gold-plated Zone 2 speaker outputs<sup>4</sup>
- Gold-plated Front L/R pre-out, Zone 2 pre-out, and Zone B line-out (analog RCA<sup>6</sup>)
- 2 subwoofer pre-outs
- Ethernet LAN terminal

### CUSTOM INTEGRATION FEATURES

- 10BASE-T/100BASE-TX Ethernet supports setup and IP control via web browser
- Works with Crestron®, Control4®, Savant, URC, ELAN, and RTI automation
- RS-232 input for external control and automation
- 2 IR inputs and 1 output
- 3 programmable 12 V trigger-outs with adjustable delay (A: 100 mA, B: 25 mA, C: 25 mA)
- Dealer-settings memory storage and recall function
- AC inlet for detachable IEC power cable
- Optional rack-mount kit (IRK-155-3D)

### ADDITIONAL FEATURES

- Aluminum front panel and volume knob
- One-touch volume memory preset assignment to individual A/V inputs via front panel
- OSD function displays A/V input signal data, output signal/settings data, and network information
- Dolby® TrueHD and DTS-HD Master Audio® decoding
- Advanced Music Optimizer™ improves compressed audio playback quality
- High-definition GUI over HDMI
- 4K to 8K, 1080p to 8K/4K video upscaling via HDMI
- Crossover Adjustment (40/45/50/55/60/70/80/90/100/110/120/130/150/180/200 Hz)
- A/V Sync Control (Up to 500 ms in 1 ms steps at 48 kHz<sup>17</sup>)
- Sleep timer, HDMI passthrough, and network standby
- 40 FM/AM/internet radio presets with station-naming (10 characters)
- 3-Mode display dimmer (Normal/Dim/Dimmer)

<sup>1</sup> Features defined in HDMI 2.1 specification, HDR10+, and passthrough capabilities described are supported on HDMI inputs 1–3, Main Out, and Sub/Zone 2 Out in Sub Mode output. <sup>2</sup> DSC signals only. <sup>3</sup> HDMI Zone 2 Mode output supports signals via HDMI inputs 1–3. <sup>4</sup> Playback via Height (5.2.2-ch layout) or Surround Back (7.2-ch layout) speaker outputs is unavailable when playing in 5.2-ch + Zone 2 speaker output mode. Output via Zone 2 speaker output and Zone 2 pre-out enabled. <sup>5</sup> Zone 2 HDMI audio is available on inputs 1–3. SPDIF and HDMI support PCM signals only. <sup>6</sup> Zone 2 pre-out, Zone B line-out, and Front L/R pre-out are exclusive modes shared on the same analog RCA output. <sup>7</sup> Some countries or regions have regulations that affect wireless signal strength and the use of Wi-Fi channels. <sup>8</sup> Amazon Music HD is supported via DTS Play-Fi. <sup>9</sup> Service availability varies with region, and a paid subscription may be required. <sup>10</sup> Requires Sonos Connect or Port (sold separately). Connection of 1–2 Sonos devices is supported with volume control enabled via the Sonos app. Sonos app available free for compatible iPhone® and iPad® at the App Store. Available free for compatible Android™ devices at the Google Play Store. <sup>11</sup> Voice control requires an Amazon Alexa enabled device. Alexa multi-room music may require a firmware update. <sup>12</sup> Voice control requires a Google Assistant enabled device. <sup>13</sup> Enabled with a future firmware update. <sup>14</sup> Available free for compatible iPhone, iPad, and Android devices. <sup>15</sup> Converted to PCM. Playback not guaranteed via wireless LAN. <sup>16</sup> Supported sampling rates may vary depending on network environment. ALAC is supported to a maximum 96 kHz. <sup>17</sup> Max. 400 ms (1 ms steps) at 96 kHz, and max. 200 ms (1 ms steps) at 192 kHz.

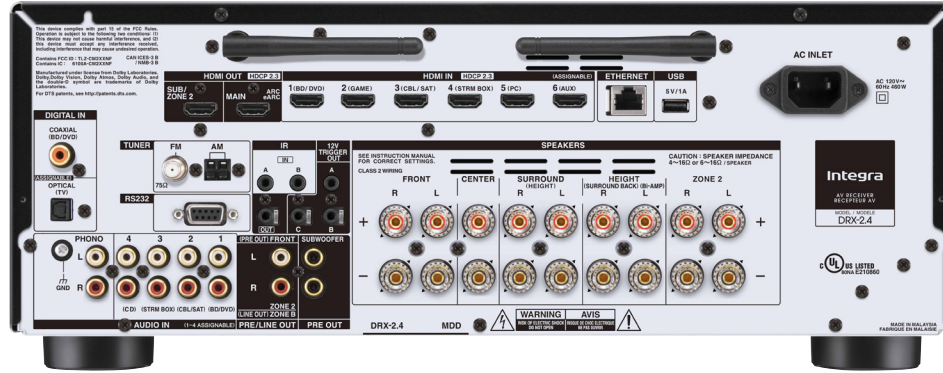

### SPECIFICATIONS

#### AMPLIFIER SECTION

**Power Output**  
 Front L/R: 170 W/Ch at 6 Ohms, 1 kHz, 10%,  
 1 Channel Driven,  
 80 W/Ch at 8 Ohms, 20 Hz–20 kHz, 0.08%,  
 2 Channels Driven, FTC

**Dynamic Power:**  
 160 W (3 Ohms, Front)  
 125 W (4 Ohms, Front)  
 85 W (8 Ohms, Front)

**Input Sensitivity and Impedance:**  
 200 mV rms/47 k-Ohms (Line/Unbalance)  
 3.5 mV rms/47 k-Ohms (Phono MM)

**THD+N (Total Harmonic Distortion + Noise):** 0.08% (20 Hz–20 kHz, Half Power)

**Rated RCA Output Level and Impedance:**  
 1 V rms/470 Ohms (Pre-out/Subwoofer Pre-out)  
 200 mV rms/470 k-Ohms (Zone B Line-out)

**Phono Overload:** 70 mV (MM, 1 kHz, 0.5%)

**Frequency Response:** 10 Hz–100 kHz/+1 dB, -3 dB (Direct Mode)

**Tone Control:**  
 ±10 dB, 20 Hz (Bass)  
 ±10 dB, 20 kHz (Treble)

**Signal-to-Noise Ratio:**  
 106 dB (IHF-A, Line)  
 80 dB (IHF-A, Phono)

**Speaker Impedance:** 4 Ohms–16 Ohms

#### TUNER SECTION

**Tuning Frequency Range:**  
 FM 87.5 MHz–107.9 MHz  
 AM 530 kHz–1,710 kHz

**FM/AM Preset Memory:** 40 Stations

#### GENERAL

**Power Supply:** AC 120 V~, 60 Hz

**Power Consumption:** 460 W

**Standby Power Consumption:** 0.1 W

**Dimensions (W x H x D):** 17 1/8" x 6 7/8" x 14 13/16"  
 (435 x 174 x 376.5 mm)

**Weight:** 21.2 lbs. (9.6 kg)

**CARTON**

**Dimensions (W x H x D):** 22 1/16" x 12" x 18 3/8"  
 (560 x 305 x 467 mm)

**Weight:** 21.2 lbs. (9.6 kg)

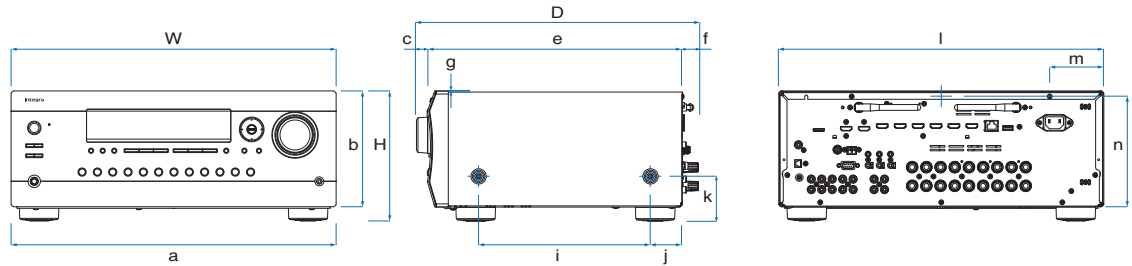

W	H	D	a	b
17 1/8" (435 mm)	6 7/8" (174 mm)	14 13/16" (376.5 mm)	17 1/8" (435 mm)	6 1/8" (155 mm)
c	e	f	g	i
15/16" (24.5 mm)	13" (330.5 mm)	7/8" (21.5 mm)	1/16" (1.5 mm)	9 1/16" (229.5 mm)
j	k	l	m	n
1 11/16" (42.5 mm)	2 3/8" (60.8 mm)	17 1/16" (433 mm)	2 13/16" (71.5 mm)	6 5/8" (167.5 mm)

Due to a policy of continuous product improvement, Integra reserves the right to change specifications and appearance without notice. Dolby, Dolby Atmos, Dolby Surround, Dolby Vision, and the double-D symbol are trademarks of Dolby Laboratories. For DTS patents, see <http://patents.dts.com>. Manufactured under license from DTS Licensing Limited. DTS, the Symbol, DTS and the Symbol together, DTS:X logo, DTS Virtual:X and the DTS Virtual:X logo, DTS Neural:X and the DTS Neural:X logo, and Play-Fi and the Play-Fi logo are registered trademarks or trademarks of DTS, Inc. © DTS, Inc. All Rights Reserved. The terms HDMI and HDMI High-Definition Multimedia Interface, and the HDMI Logo are trademarks or registered trademarks of HDMI Licensing Administrator, Inc. in the United States and other countries. SONOS is a trademark of SONOS, Inc. The Bluetooth® word mark and logos are owned by the Bluetooth SIG, Inc. AirPlay, Siri, iPad, and iPhone are registered trademarks of Apple Inc. Google, Android, Chromecast built-in, and other related marks are trademarks of Google LLC. Wi-Fi® is a registered trademark of the Wi-Fi Alliance. The Wi-Fi CERTIFIED Logo is a certification mark of the Wi-Fi Alliance. Roon is a trademark of Roon, LLC, registered in the U.S. and other countries. Spotify and the Spotify logo are trademarks of the Spotify Group, registered in the U.S. and other countries. Products displaying the Hi-Res Audio logo conform to the Hi-Res Audio standard as defined by Japan Audio Society. The Hi-Res Audio logo is used under license from Japan Audio Society. PANDORA, the PANDORA logo, and the Pandora trade dress are trademarks or registered trademarks of Pandora Media, Inc. Used with permission. Amazon, Alexa, Amazon Music, and all related logos are trademarks of Amazon.com, Inc. or its affiliates. Qualcomm is a trademark of Qualcomm Incorporated, registered in the United States and other countries. aptX is a trademark of Qualcomm Technologies International, Ltd., registered in the United States and other countries. Qualcomm aptX is a product of Qualcomm Technologies, Inc. and/or its subsidiaries. Integra Remote, Integra Music Control App, Music Optimizer, AccuEQ, and VLSC are registered trademarks or trademarks of Onkyo Home Entertainment Corporation. All other trademarks and registered trademarks are the property of their respective holders.

## Downloads and More

Download available media for new 2021 products below:

[https://www.dropbox.com/sh/ib6uhc9zjg43hw0/  
AACbjt8J6wAnwXkmuytsD1rva?dl=0](https://www.dropbox.com/sh/ib6uhc9zjg43hw0/AACbjt8J6wAnwXkmuytsD1rva?dl=0)

## Additional Information

Website: <http://www.integrahometheater.com>

Inquiries: [Turnitup@11tradingcompany.com](mailto:Turnitup@11tradingcompany.com)